

1. THE TECHNICAL APPROVAL OF DRAFT LAYOUT OF HYDERABAD METROPOLITAN DEVELOPMENT AUTHORITY District Commercial Complex, Tonkha, Hyderabad - 500007 with Layout Permit No. 00263/L2/Plg/HMDA/2018, Dated 11/12/2018, File No. 014971/SKP/LT/16/HMDA/0692018 Dt: 11/12/2018. Layout Plan approved in Sy. No. 213P of Bhanoor village covering an extent of 22421.65 Sq.m is accorded subject to following conditions:
2. The Layout Number issued does not exempt the lands under reference from purview of Urban Land Ceiling Act 1976.
3. This permission of developing the land shall not be used as proof of the title of the land. And if any litigation / court cases to settle the matter by the applicant / developer & not made party of HMDA and its Employees.
4. The applicant shall solely be responsible for the development of layout and in no way HMDA will take up the development work as per specifications given in Lr. No. 014971/SKP/LT/16/HMDA/0692018 Dt: 11/12/2018.
5. The Deed of Mortgage by conditional sale executed by the applicant in favour of HMDA is purely a measure to ensure compliance of the condition of development of infrastructure by the applicant / developer and HMDA is no way accountable to the plot purchaser in the layout of default by applicant / developer.
6. The applicant / developer are directed to complete the above developmental works within a period of 3 years and submit a requisition letter for releasing of mortgage plots / area which is in favour of METROPOLITAN COMMISSIONER, HMDA duly enclosing letter to Municipal Commissioner / Executive Authority in regards to roads and open spaces taken over by the Executive Authority before release of the Final Layout Plan.
7. The applicant shall not be permitted to sell the plots/area which is in mortgage in favour of HMDA i.e. from Plot No(s) 1 to 6 (Total 06 plots) to an extent of 22421.65 Sq.mts and Local Body shall ensure that no developments like building authorized or un-authorized should come in the site until Final Layout Approval by HMDA.
- 8) The applicant is permitted to sell the plots, other than mortgaged plots as mentioned in item no. 7 above.
- 9) The Municipal Commissioner/Executive Authority shall not approve and release any building permission or all any un-authorized developments in the area under mortgage to HMDA in particular and in other plots of the layout in general until and unless the applicant has completed the developmental works and then get released the mortgaged land from HMDA.
- 10) The Layout applicant shall display a board at a prominent in the above site showing the layout pattern with permit LP No. and with full details of the layout specifications and conditions to facilitate the public in the matter.
- 11) Zonal Commissioner/Municipal/Executive Authority should ensure that the open spaces shall be developed by the applicant along with other development with ornamental compound wall and grill as per sanctioned layout plan.
- 12) The CHMC/Municipal Gram Panchayat shall ensure that areas covered by roads and open spaces of the layout shall take care and not allow any type of construction in the layout and collect undertaking before release of Draft Layout Plan after collecting the necessary charges and fees as per their rules in force.
- 13) This permission does not for any public agency including HMDA/Local Body to acquire the lands for public purpose as per law.
- 14) The applicant / developer shall comply the conditions mentioned in the G.O.M.No. 33 MA Dt: 24-01-2013, G.O.M.No. 168 MA Dt: 07-04-2012, G.O.M.No. 246 MA Dt: 30-06-2012, G.O.M.No. 276 MA Dt: 02-07-2010, G.O.M.No. 526 & G.O.M.No.527.

DATE: 11-12-2018 SHEET NO.: 01/01

AREA STATEMENT HMDA

PROJECT DETAIL :

| | |
|---|--|
| Authority: HMDA | Plot Use - Residential |
| File Number: 014971/SKP/LT/16/HMDA/0692018 | Plot Sub/Use - Residential Bldg |
| Application Type - General Proposal | Plot/Nearby/Religious/Structure - NA |
| Project Type - Open Layout | Land Use Zone - Residential |
| Nature of Development - New | Land Sub/Use Zone - Residential zone-1 (urban areas contiguous to growth corridor) |
| Location - Extended area of Erstwhile HUDA (HMDA) | Abutting Road Width - 30.00 |
| Sub/Location - New Areas / Approved Layout Areas | Survey No. - 213p |
| Village Name - Bhanoor | North - |
| Mandal - Patancheru | South - |
| | East - |
| | West - |

AREA DETAILS :

| AREA OF PLOT (Minimum) | (A) | SQ.MT. |
|------------------------|----------------|----------|
| NET AREA OF PLOT | (A-Deductions) | 22421.65 |
| Road Widening Area | | 1858.98 |
| Amenity Area | | 0.00 |
| Total | | 1858.98 |
| BALANCE AREA OF PLOT | (A-Deductions) | 22421.65 |
| Vacant Plot Area | | 22421.65 |

LAND USE ANALYSIS

| | |
|---|----------|
| Plotted Area | 14452.84 |
| Road Area | 5570.18 |
| Organized open space/Park Area/Utility Area | 1836.52 |
| Social Infrastructure Area | 562.11 |

BUILT UP AREA CHECK

| | |
|---|------------|
| MORTGAGE AREA IN PLOT NO(S) 1 TO 6 (TOTAL 06 PLOTS) | 2247.51 |
| ARCH / ENGG / SUPERVISOR (Regd) | Owner |
| DEVELOPMENT AUTHORITY | LOCAL BODY |

COLOR INDEX

| | |
|-----------------------|--------|
| PLOT BOUNDARY | Black |
| ABUTTING ROAD | Green |
| PROPOSED CONSTRUCTION | Red |
| COMMON PLOT | Yellow |
| ROAD WIDENING AREA | White |

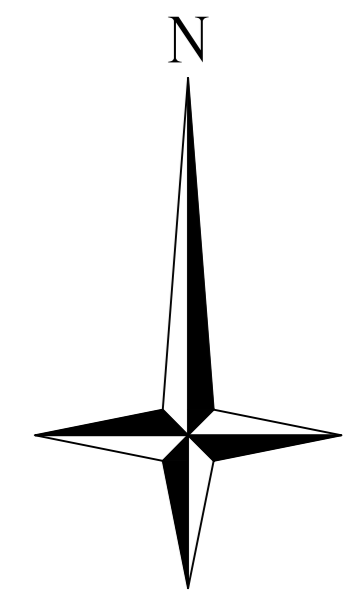

SY.NO.213/P

SY.NO.213/P

>> TO BHANUR

EXISTING 33' & PROP. 100' (30.0m) WIDE ROAD

<< TO LAHARI RESORTS

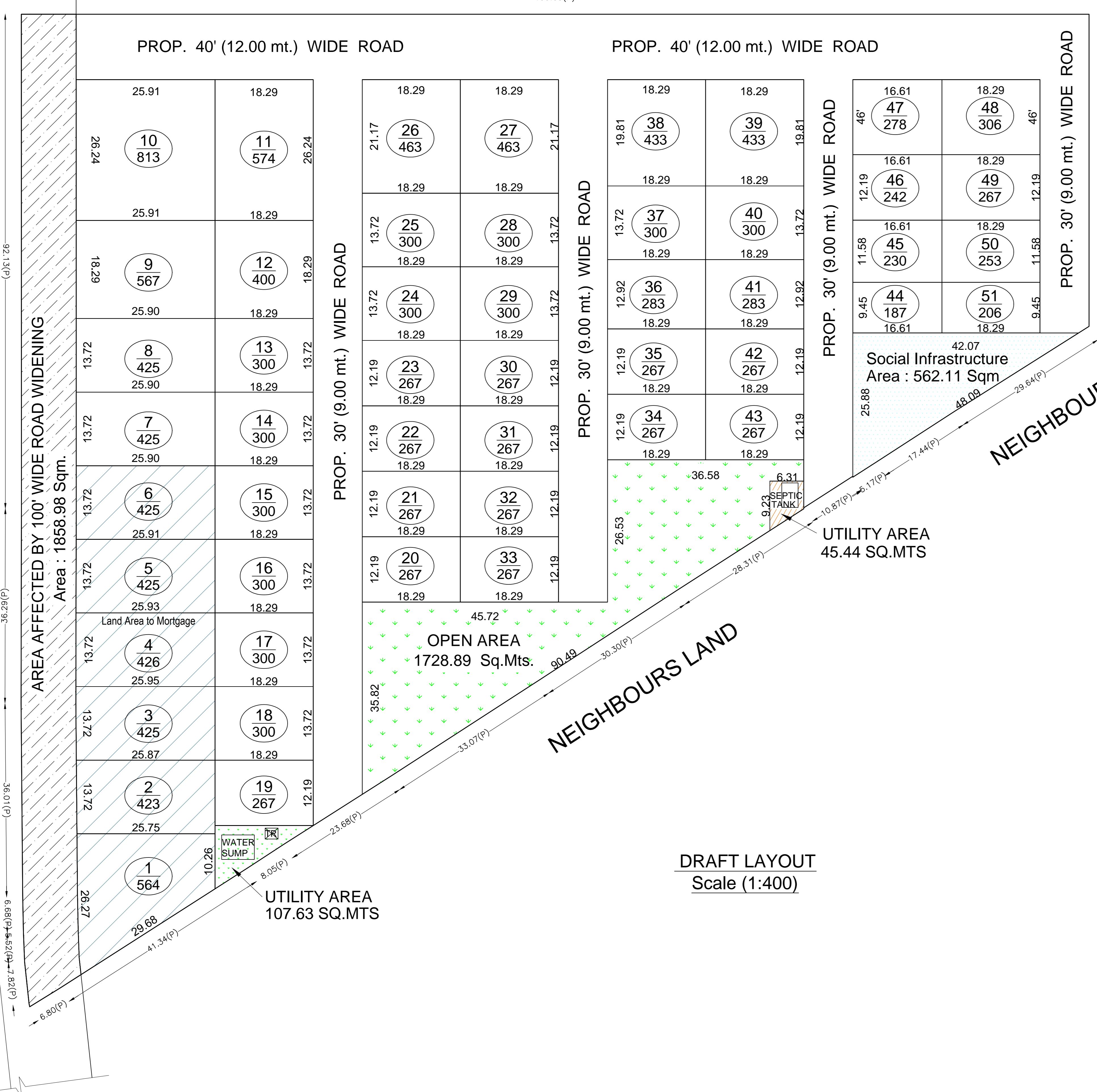

DRAFT LAYOUT
Scale (1:400)

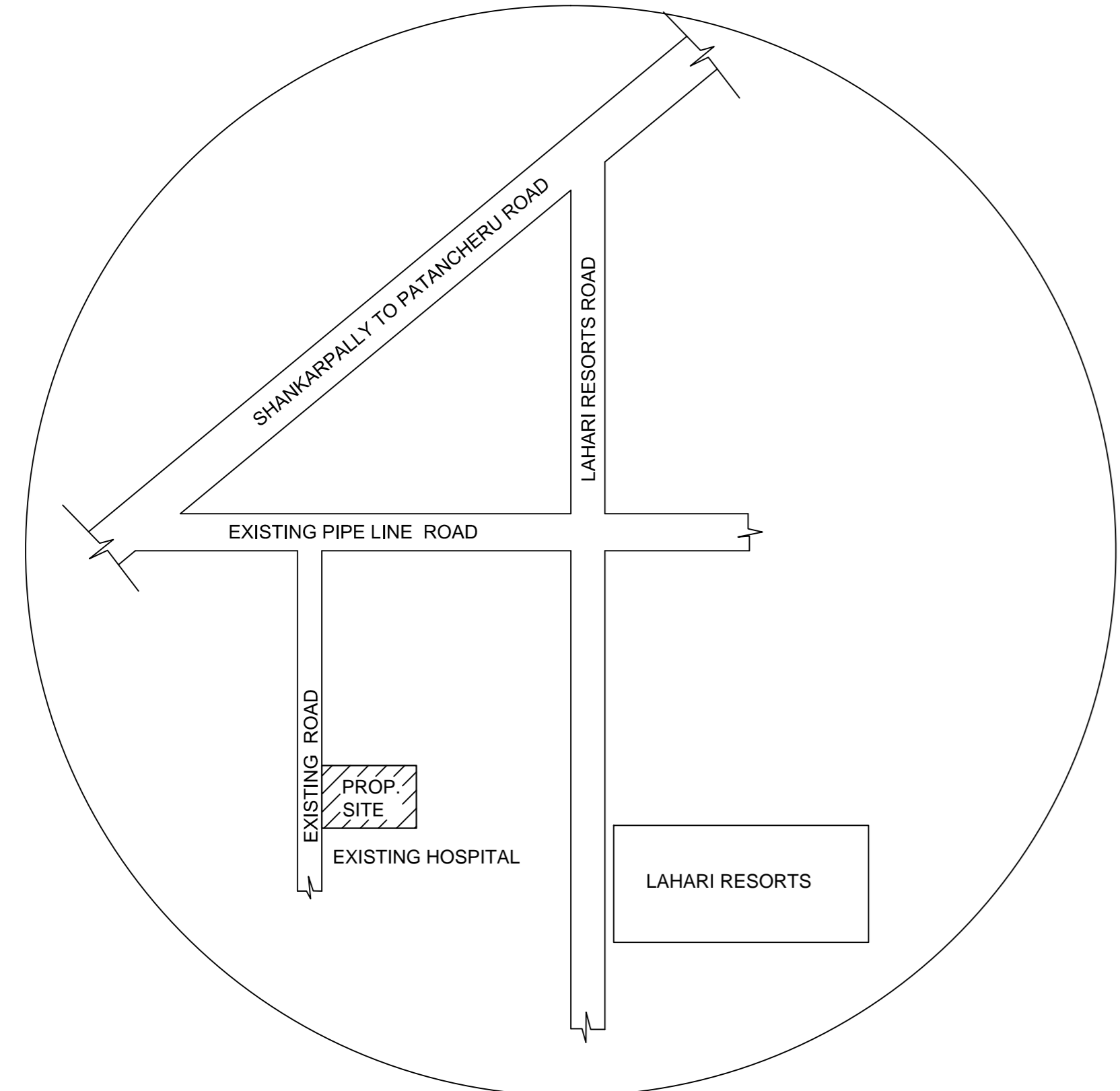

LOCATION PLAN
Not to Scale

| | |
|--------------------|---|
| OWNER'S SIGNATURE | ARCHITECT'S SIGNATURE |
| <i>(Signature)</i> | <i>(Signature)</i> NAGANJANEYULU, K ARCHITECT CA/2008/4080 |